

**Waterford Estate**  
 55 Long Island Road, Murray Bridge South Australia 5253  
 Phone: 08 8531 3630 | Email: [warvets@rslcaresa.com.au](mailto:warvets@rslcaresa.com.au)  
[www.rslcaresa.com.au](http://www.rslcaresa.com.au)



RSL CARE SA

Waterford Estate is owned and operated by RSL Care SA, a proud not for profit charitable organisation, whose Corporate Office is located at 55 Ferguson Avenue, MYRTLE BANK SA 5064

© All photos, illustrations and floor plans represented are for illustration purposes only. All sizes are approximate. The seller, its related companies, agents and representatives do not make any warranty as to the accuracy of these preliminary plans nor that they will not change. The prospective resident should note that the seller is permitted to make changes to the preliminary plans at any time before construction is complete. All designs, prices and specifications are subject to change without notice. The prospective resident should refer to the licence to occupy contract for full details. Effective from September 2023.

# 8 ACORN COURT BULLNOSE VERANDAH COTTAGE



LIVING IN  
GOOD  
COMPANY

Waterford Estate is a picturesque retirement village superbly located by the peaceful Murray River with walking trails, Community Centre and a vibrant and welcoming community.



## 8 ACORN COURT BULLNOSE VERANDAH COTTAGE

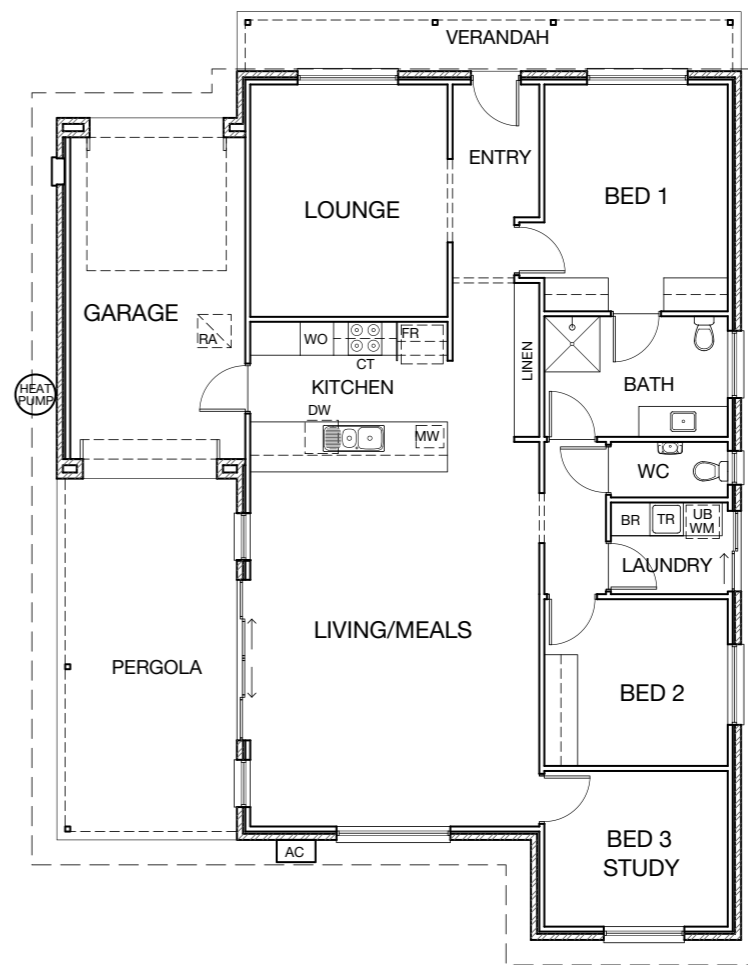

Living	131.00 sqm
Garage	21.80 sqm
Verandah	9.69 sqm
Pergola	21.00 sqm
<b>Total</b>	<b>183.49 sqm</b>

- 3
- 1.5
- 2
- 1

This Bullnose Verandah Cottage features 2 bedrooms with built-in-ropes and either a Study or 3rd bedroom. There is a separate lounge room in addition to the large kitchen, living and dining area that opens to the undercover pergola for outdoor entertainment. The single car garage has direct access to the home, there is a two-way bathroom, separate toilet, and separate laundry with direct access to the secure outside yard.

Indicative floorplans